



MI IATEUR - CLASS WORK

HOPE VILLAGE

Eco-district in Guadeloupe.



iateur

Localisation of Saint-Anne

in Guadalupe

An area of 80 Km²

An approximate population
of 23,675 inhabitants

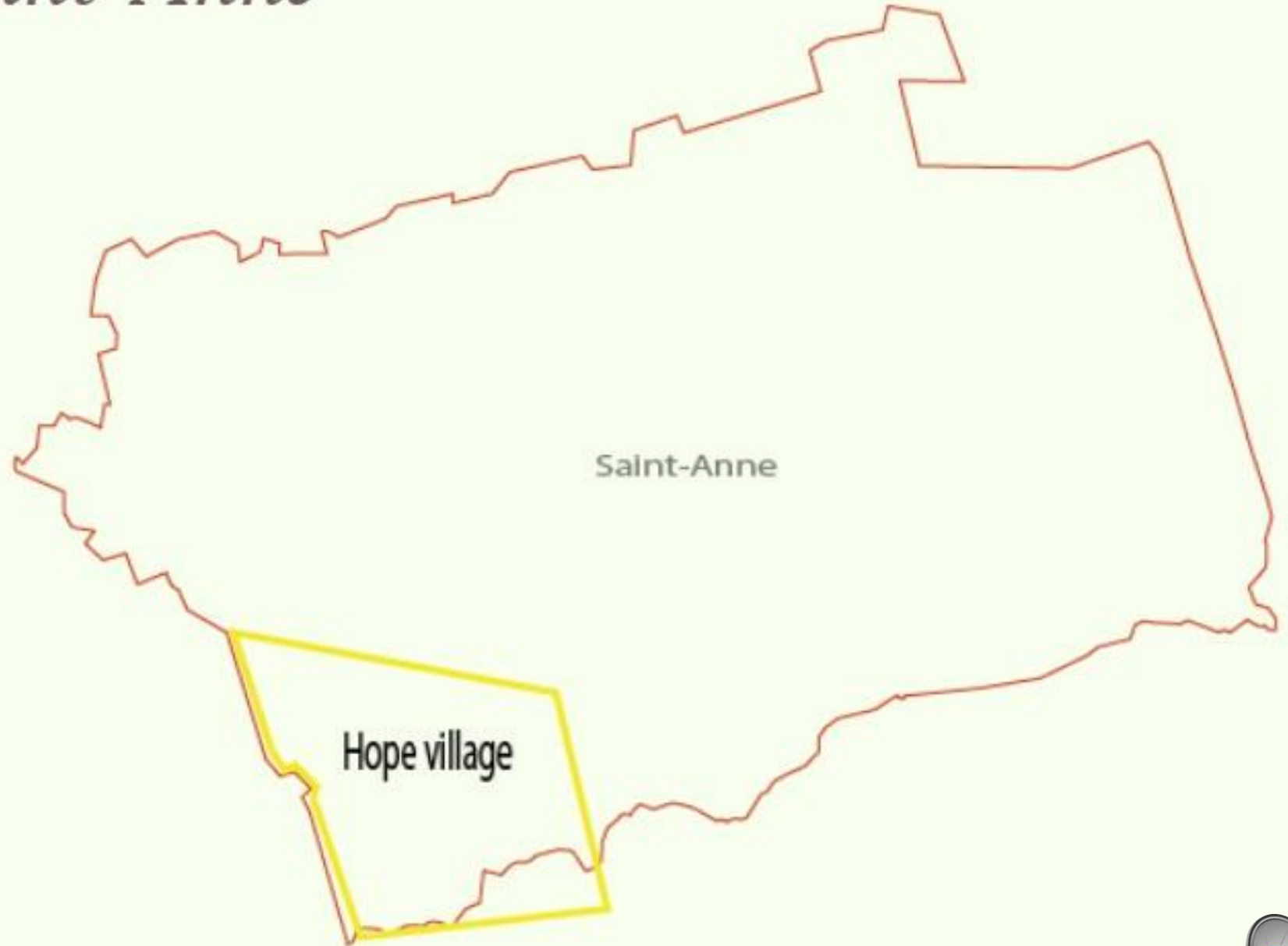



Hope village planning representation



ECO DISTRICT

HOPE VILLAGE



BUDGET AND CONSTRUCTION AREA



4 970 dwellings

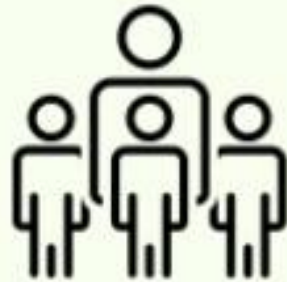

10 000 family



828 buildings



124 250 000€



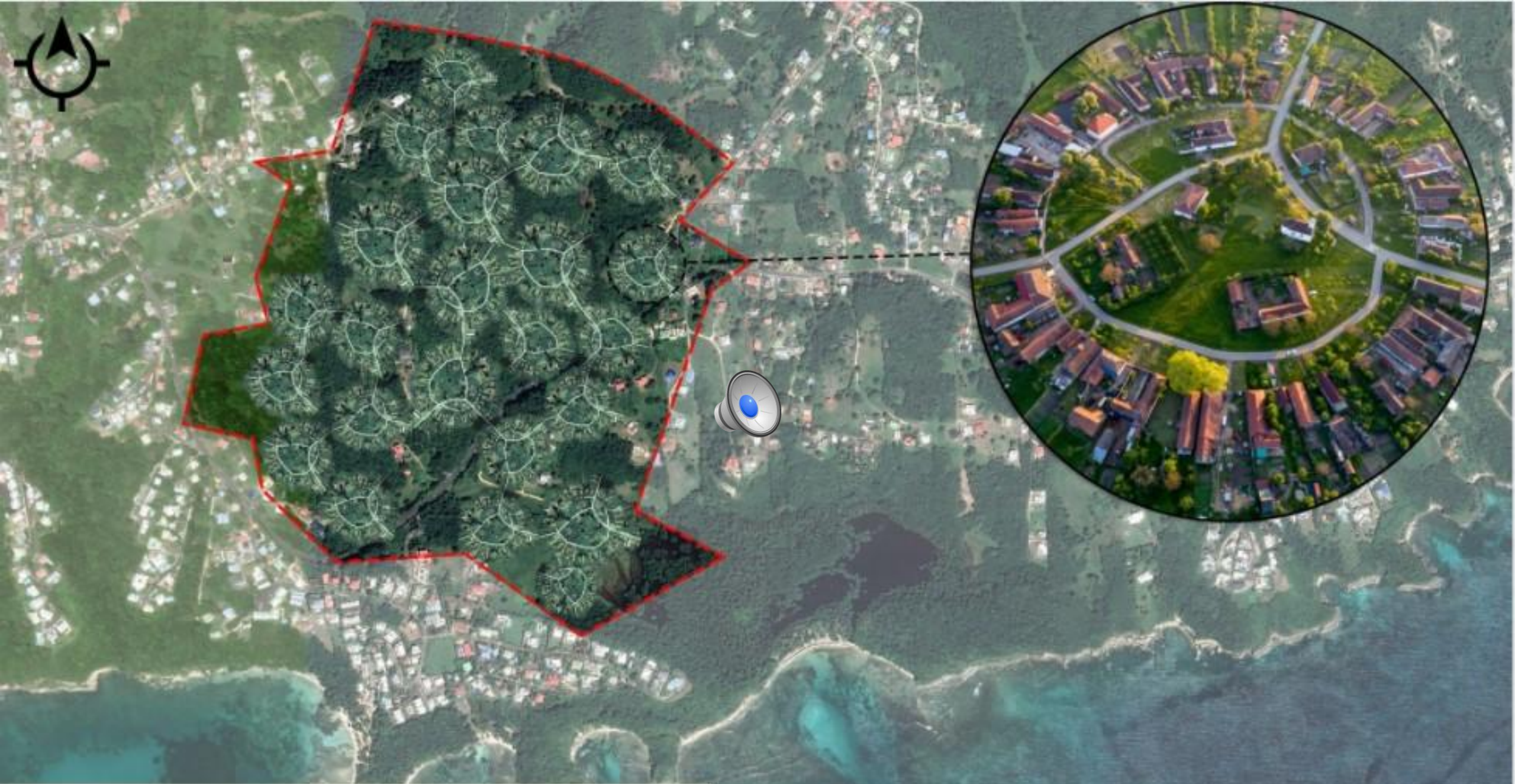

Plaining representation of dawallings

PRESENTATION OF A TYPICAL RESIDENCE

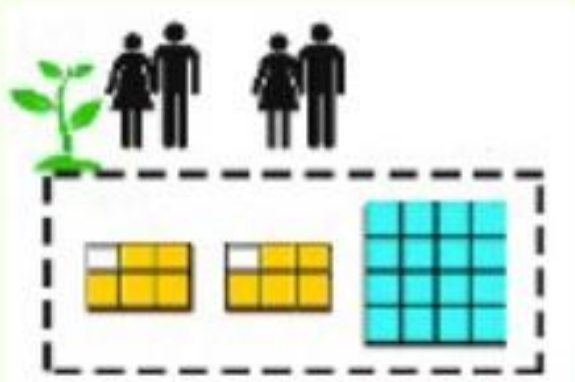

- **The modular residence:** Houses can have two to five rooms, depending on the needs of the household.
- **Materiality:** The modules are made from recycled materials.

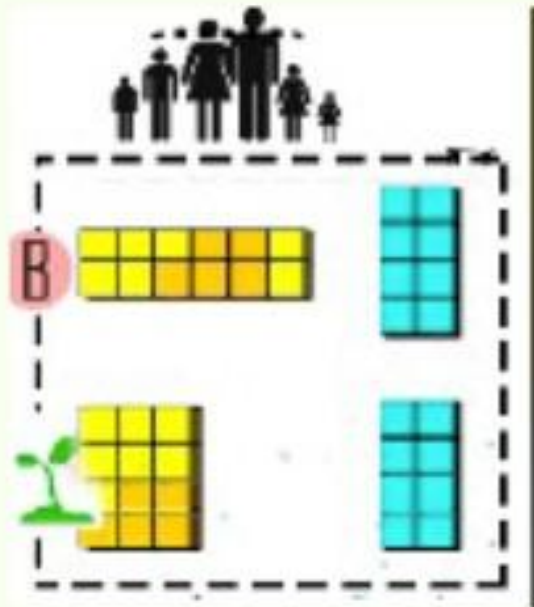
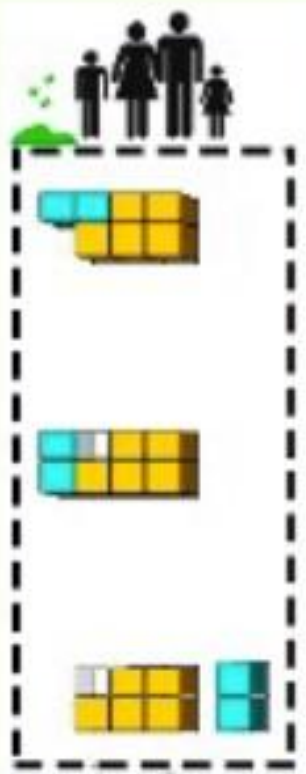



RENEWABLE ENERGIES

The buildings are equipped with solar panels on the roof and an electricity storage system in each dwelling.

RAINWATER HARVESTING

It is a collection system through canals and pipes that lead to an underground storage tank.

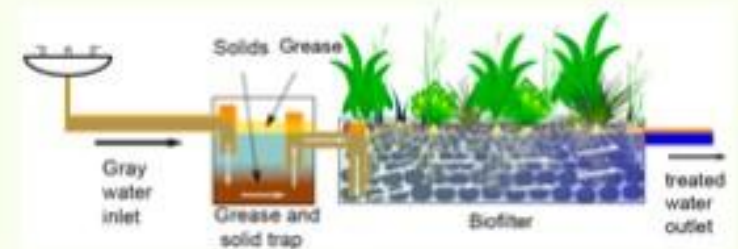
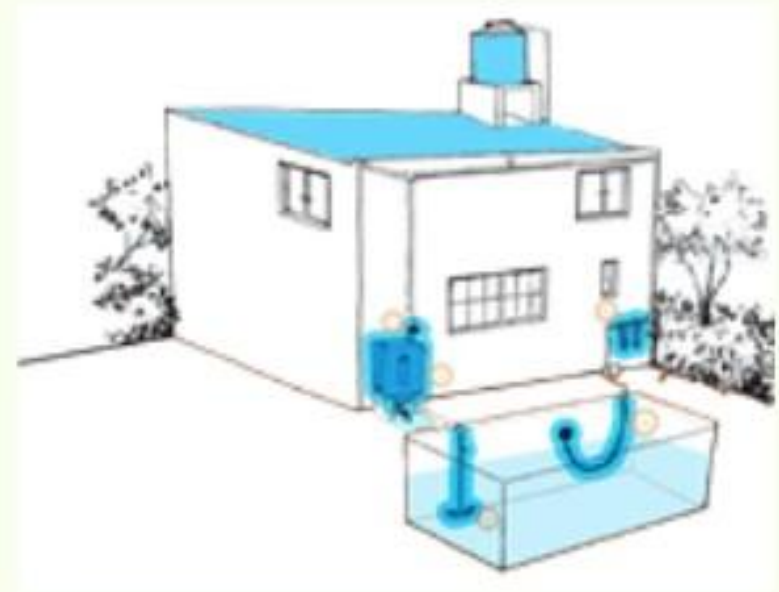

PRESENTATION OF A TYPICAL HOME



CONSTRUCTION METHODS

- **structure:** The natural wood will be used for the foundation and to make the constructions flexible. The foundations are built on piles to adapt to the natural relief of the land. Recycled tyres filled with concrete are also used to make the construction bases.
- **Baregue system:** the straw will be used as natural thermal insulation for the house. The insulation will be completed with earth.
- **Roof:** Natural clay tile. The solar panels will supply the house with electricity.
- **Floor:** natural wood and tile
- **N° floor:** Modular house built on 2 floors from T2 to individual house T5





TYPICAL EXAMPLE OF A T3 OF 87M²

- One level
- Two bedrooms
- A bathroom with shower and WC
- A living room with an open kitchen in the centre of the flat
- An outdoor foldable greenhouse attached to the flat





The North side of the houses:
ventiltion system



The south side of the houses: isolation
plant



GREEN SPACES

The green spaces of the village **will be highlighted.**

Practical use of the spaces the gardens will be at the center.



The gardens will serve as the **common space**

A **shared greenhouse** will be dedicated to **traditional agriculture**

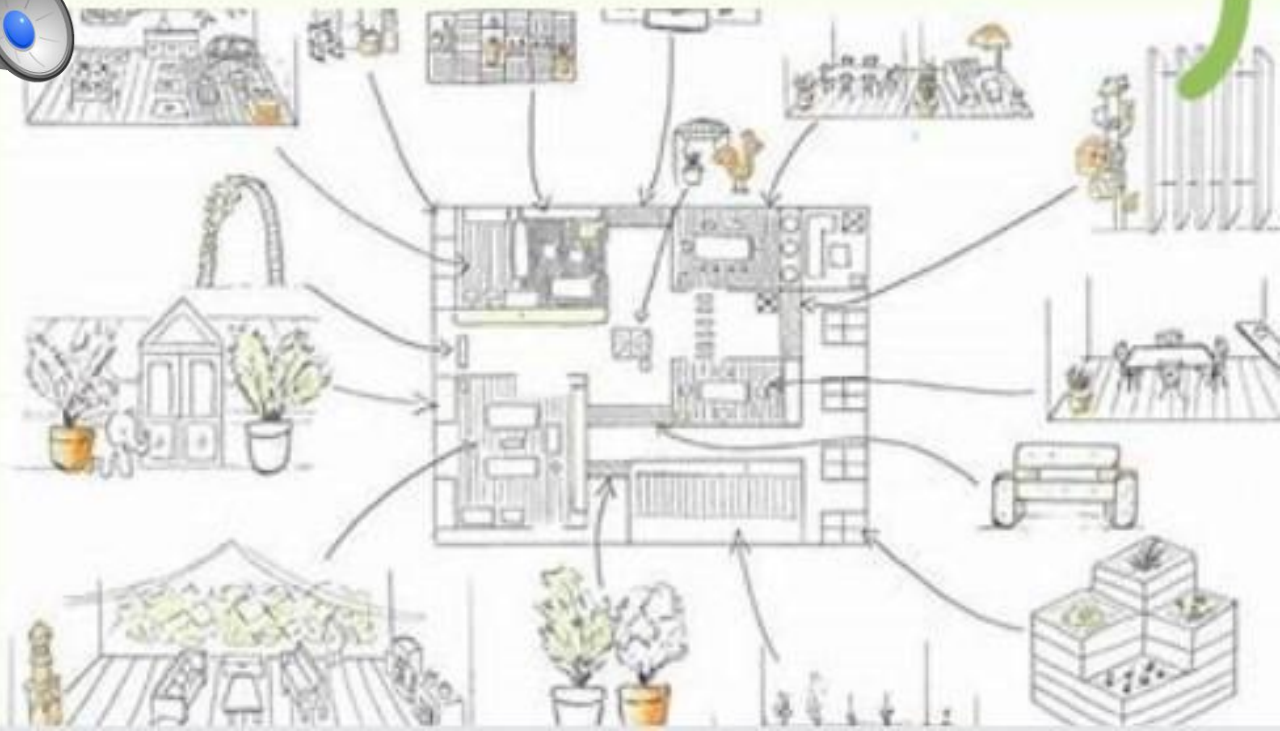



Public Spaces and Energy





Central square near the town hall

- Large space
- Organize events throughout the year
- Permeable place
- Green and mineral space



Budget : Public square



Public square	Price (€)	Quantity	Total (€)
Draining paving stones	25€ / m ²	2 500 m ²	62 500
Vegetation (flowers, trees)	100€/tree flowers	12 trees a lot of	2 000
Bench	500	4	2 000
TOTAL			66 500

Park in the back of the town hall



A space devoted to sport and play



A space for teenagers



A space of tranquility



RELAX



Second park : the culture and the rest



Book box



Hammocks



Cultural signs



Exhibitions of local artists

Third Park : Biodiversity and social cohesion



Shared educational garden



Insect hotel and birdhouses



A pool



Budget : Park's equipments



Park's equipments	Price (€)	Quantity	Total (€)
Field	2M / hectare	10 hectare	20M
Playground	10 000	2	20 000
Ping pong table	800-900	3	2 700
Park bench	500	40	20 000
Insect hotel	100	1	100
Hammock	100	10	1 000
Wooden decks chairs	300	10	3 000
Bookshelf	300	3	900
Swing set	1500	3	4500
Vegetations (flowers, trees)	trees + flowers	a lot of	16 500
TOTAL			20 068 700



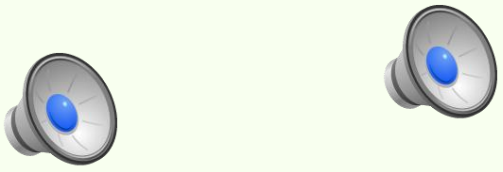

Energy



Solar farm



Stuck up rainwater



Wind turbine

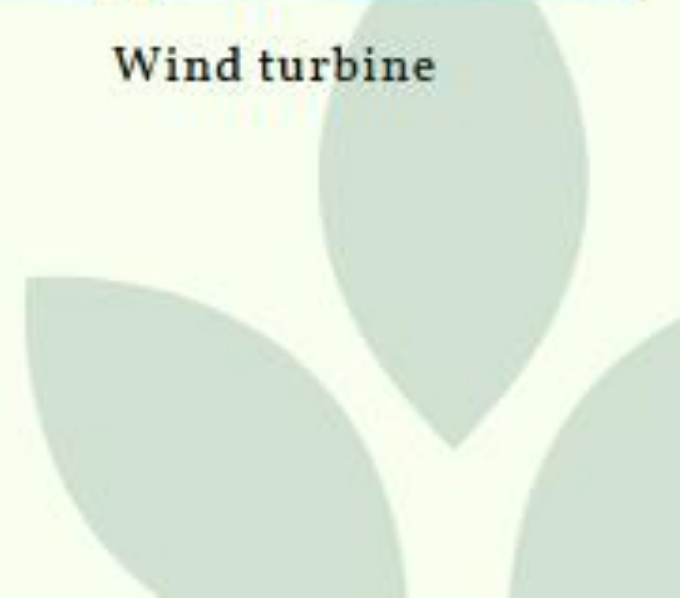



Budget : Energy



Energy's equipments	Price (€)	Quantity	Total (€)
Solar farm	430 000	1	430 000
Wind turbine	1M	2	2M
Stock up rainwater	2 000	10	20 000
TOTAL			2 450 000

An aerial photograph of a tropical coastline. A long, narrow stone breakwater extends from the shore into the clear, turquoise water. The breakwater divides the beach into two sections. The water is exceptionally clear, revealing the sandy bottom and some dark rocks. The beach is a mix of light and dark sand. To the right of the beach, there is a dense line of green trees and vegetation, including palm trees. The overall scene is serene and idyllic.

Economy, Leisure and tourism



Brief presentation



Building an eco-friendly village



Being sustainable (social, economy and environment)





Location of the site



Objectives



- The eco-neighborhood project is located in Guadeloupe, close to the main city (Pointe-à-pitre).
- Making the link between tourism and sustainable development
- The beach as an economic driver for the neighborhood



Building an ambitious museum

An eco-museum

- Promoting local gastronomic patrimony
- A multicultural identity
- Create a cultural strength



A double purpose museum



A guadeloupean Louvres museum

- Import a couple of major work of art
- Give a voice to local artists
- Create a landmark





Short-circuit

Fresh SEA-Food

Market Halls

fresh land products



- *Democratize these nearby circuits*
- *Do without intermediaries*
- *Contact with fresh products*
- *Connect as much as possible fresh seafood and fresh land products*
- *Make it as easy as possible for residents to buy fresh*
- *Short circuit to catering outlets for our children*



activities



Assessment activity

I

II

III



Activities nautic



Removable sport equipment



Food seller



traditional festival activity



July in Sainte-Anne



music festival



the patronal feast



Cottages

Local attractiveness



Circular economy

Tourism



Local culture





Sustainable transport

"Trans'soukwé" transport company



WE WANTED TO HAVE A STYLISH AND ENVIRONMENT-FRIENDLY MODE OF TRANSPORT.



Sustainable transport proposal



Create pedestrian areas

Offer low-cost transports cards

Create carpool parking lots

Offer cars by carsharing

Promote river transports and bicycles
cargo for
delivery

Use more eco-friendly materials to
build cars and bike

Create green and secure bicycle paths





THE CHALLENGENCES OF SUSTAINABLE TRANSPORT



Limit carbon footprint

Promote biofuel

*Limit noise pollution
and atmospheric
pollution*

Promote walking

*Limite the use of
individual car*

*Favour public
transport*

CREATION OF MEMBERSHIP CARD



- **LOW PRICE**

Price for one-years : 300 euros
Reduced price for students,
unemployed and retired person

- **POSSIBILITIES TO GAIN POINTS ON THE CARD WITHOUT PAYING**

THANKS TO :
-DRIVE PEOPLE FOR FREE
-ASSOCIATION

- **ALL KINDS OF TRANSPORT**

Bike
Public transport : buses
Fluvial shuttle
Car sharing

- **ECONOMICAL**

35% cheaper than daily car use



Reduce home-work journey



Transport company for the employees, who work in another village

Bus shuttle

50 trips round trip

Focus on the sea rather than the road

Avoid taking the car to go work

Using biofuel for boat



Technology and carsharing



- ✓ Creation of a car-sharing and carpooling service
- ✓ Service is fully managed via the "Auto-Guadeloupe" application
- ✓ Vehicle geolocation near us. Just use your phone to lock / unlock the car
- ✓ Setting up a car-sharing system for additional trips
- These cars will be electric.
- ✓ Installation of charging stations all over the city

Our Carbon Footprint



ECO-FRIENDLY MATERIAL USE IN OUR BIKES AND CAR

- Wood and corn strach for dashboard
- Green tyres without inner tube
- Seat in vegetable leather : linen, hemp or coconut fiber
- Convert car engines to electric or biofuel car
- Convert a class bike to an electric bike



GREEN CARGO SHIP FOR THE TRANSPORT OF FOODSTUFFS/ BIKE



Green cargo ship with sails

Low Emission Zone
(ZFE)

More ecofriendly than
classic cargo ship



Cargo bike

Avoid delivery
trucks

Limit air pollution
Better for health

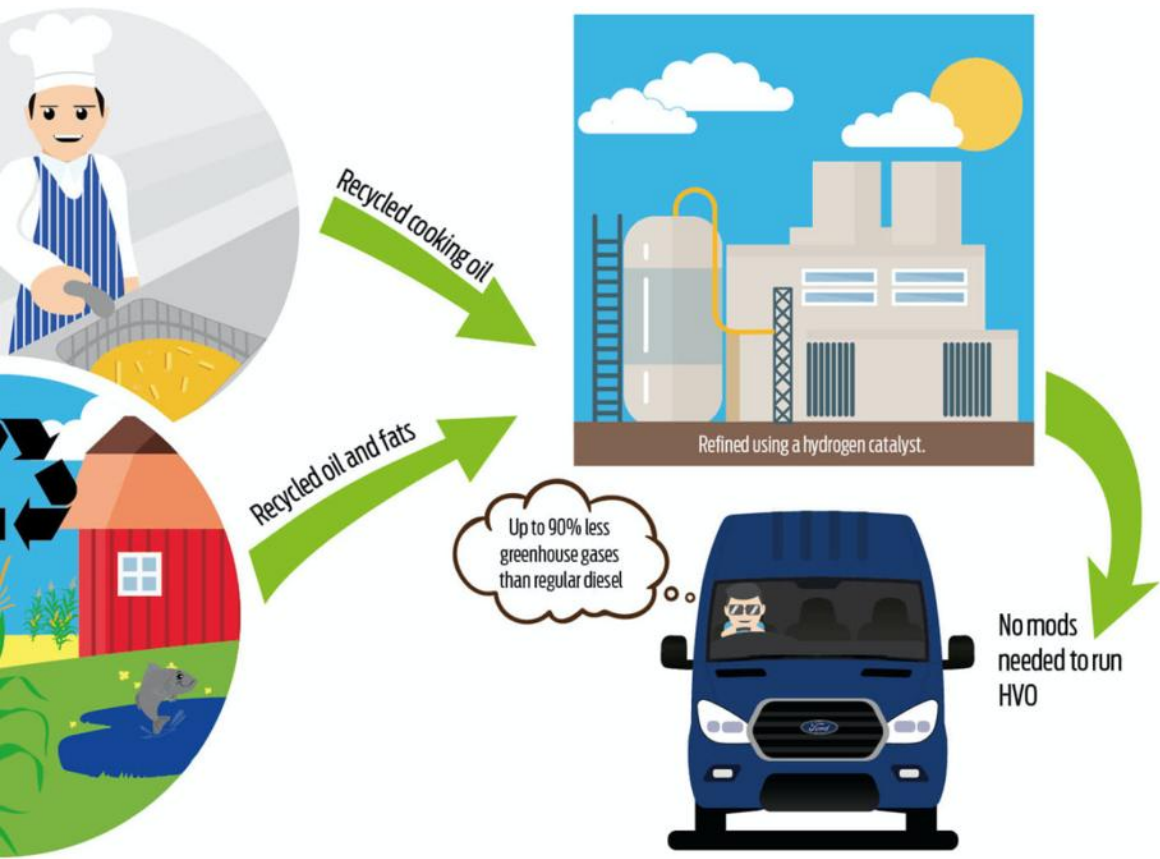

BIOFUELS

Recycled oil and fats
 Recycled cooking oil
 Use biofuel from sugar, fiber like straw



BIO-REFINERY

Transform agricultural and plant production into biofuel





THE ADVANTAGES OF SUSTAINABLE TRANSPORT

Reduced traffic congestion
Reduced greenhouse gas emissions

Reduced air pollution and related risks such as asthma

Increased physical activity : walk, bike

Increased social interaction: car sharing
Support for local businesses and vibrant economy





Thank You